

Employment Center Lease Seattle-Tacoma International Airport

SEA Employment Center Office

- Lease Terms and Conditions:
 - Five years base lease plus two one-year options
 - Rental rate will be the applicable non-aeronautical rate with CPI index annual adjustments
 - Tenant is responsible for all applicable taxes
 - Tenant is responsible for all services including internet, telephone, furniture, computers and all necessary items to operate the employment center
 - Initial location for operations center, staff office and training room will be the same as current lease
 - Relocation of space is expected due to a major capital project. Coordination with the capital project team will address impacts mitigation

SEA Employment Center Office

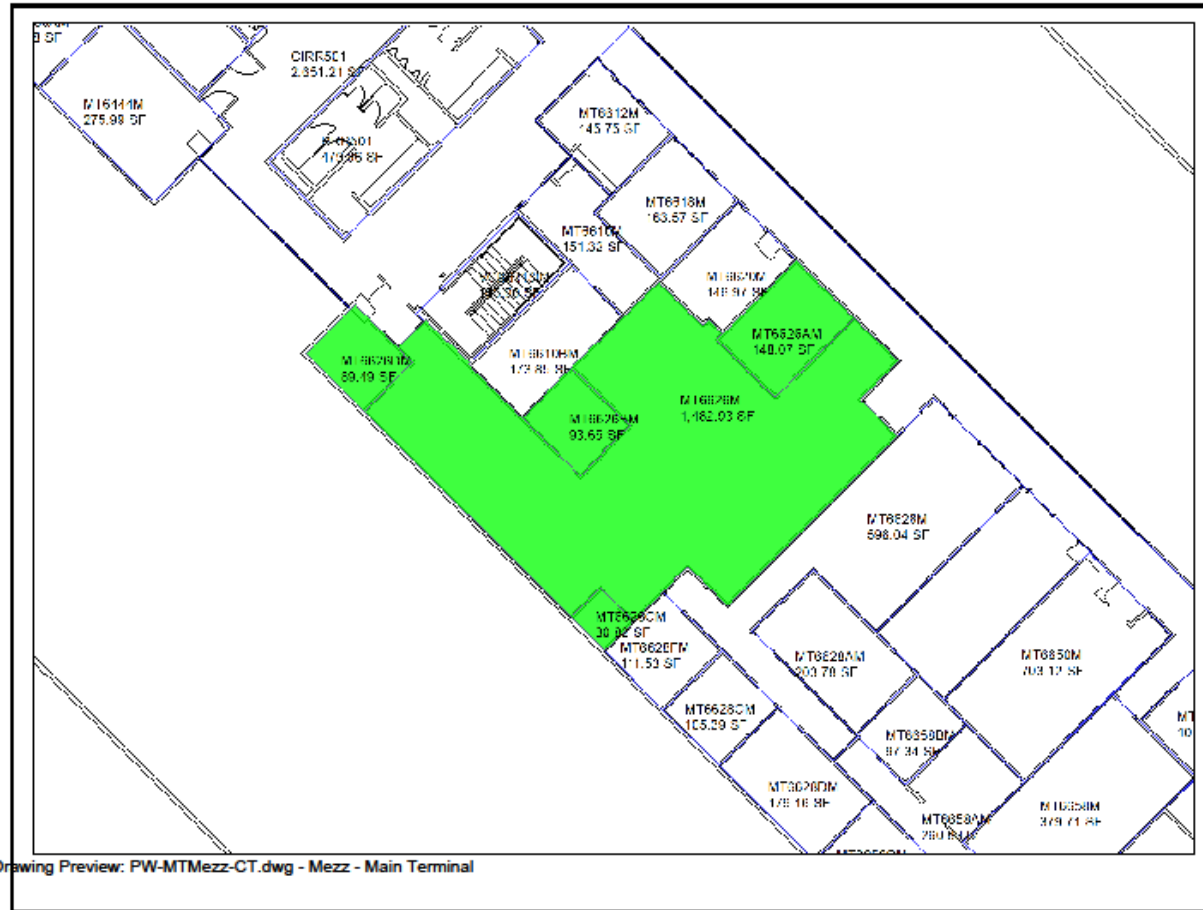

1,485 sq/ft
Located at north end of SEA on the
mezzanine level

SEA Employment Center Training Room

600 sq/ft
Located on the mezzanine level of
the central terminal area

